



schmidt
a brand of aebe schmidt

Galeox

Spreader



The Galeox is a robust, truck-mounted spreader that uses proven Stratos components to offer an outstanding price-performance ratio. The Galeox is ideal for spreading in both urban and suburban areas and offers highly efficient de-icing on country roads, urban roads, car parks, factory sites and private property. The spreader is designed for mounting on trucks with two or three axles.

Highlights

- **High dosing accuracy** with low spreading material consumption
- Design specially optimised for **tipper demount systems**
- **Suitable for both urban and suburban spreading**

Your benefits

- Dosing system with **belt conveyor system**
- **Hopper volumes of up to 7m³**
- Optional wet salt equipment enables a higher **flexibility of use**

Performance features

Concept

The Galeox is very stable as the base frame and tail section are integrated into the hopper and it uses proven Stratos components as its basis. The steel hopper is blasted and powder coated for greater corrosion protection. The spreader also has a corrosion-protected, water-tight aggregate compartment..

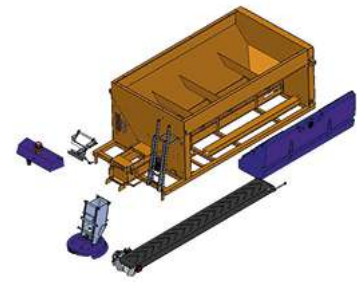

Mounting and demounting systems

The Galeox is specially optimised for tipper parking systems. And, thanks to its hopper volume of up to 7m³, it is ideal for spreading both in and out of town.

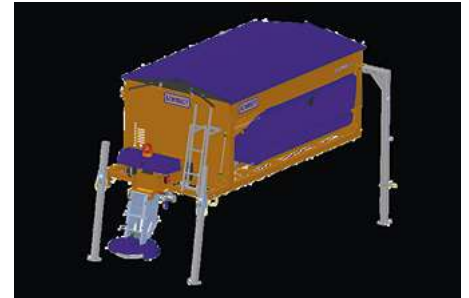

Dosage and conveyor system

The belt conveyor system ensures high dosing accuracy with low consumption of spreading material. A V-shaped, endlessly-profiled conveyor belt is used here, which runs on a sliding plate and thus leaves no bearing points in the hopper. The drive roller is mounted on low-maintenance bearings. A lump breaker and a belt relief device are also integrated.

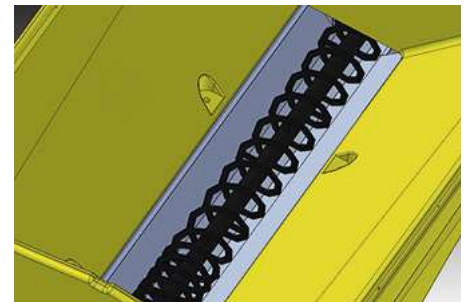

Pre-wet equipment

The spreader can be equipped with lateral brine tanks with a liquid level indicator, integral brine tank ventilation and a brine pump with run-dry protection. The size of the pre-wet tanks is approximately 30% of the hopper volume. A rear-side Storz C connection is available for filling and emptying the brine tanks. When switching on the brine (FS 30), the dry material is automatically reduced and the distribution system settings are optimised in accordance with the change in composition of the de-icing agent. The system achieves a high level of accuracy, thanks to integrated sensors for comparison of the actual versus the target value of the control loops.

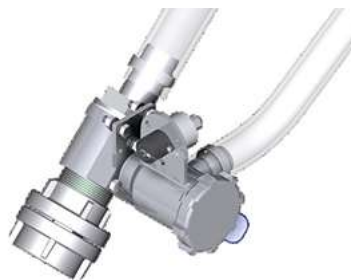
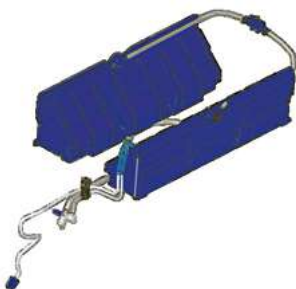

Distribution system

The distribution system is made completely of stainless steel and can be folded using gas pressure springs. The spreader has an open stainless steel chute with height adjustment to allow a smooth material flow. An asymmetrical spreading pattern adjustment is achieved by swivelling the lower end of the chute while a mixing system ensures homogeneous mixing. A 490mm diameter spreading disc is used, which allows economical use of spreading material, while the spreading width depends on material and circumstances.

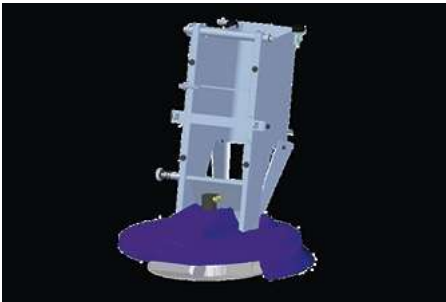

Drive options

The spreader is driven by the hydraulics of the carrier vehicle, while the diesel engine offers a classic alternative. The efficient Rotopower or a wheel drive are also available.

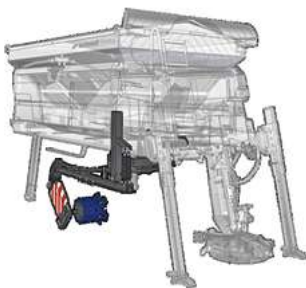

Control and information technology

A digital, fully road-speed related EC or EP control system is used, which ensures high dosing accuracy. The control unit has easy-grip click-turn knobs and illuminated push buttons - all parts are waterproof and highly resistant. The simple menu structure allows the control unit to be quickly adapted to the application conditions.



Options

- Rotating beacon (LED)
- Red and white marking
- Winter service marking
- Splash guard 2,000 or 2,200mm



Related product

Stratos 4.0 - 12.0 m³

Spreader



Stratos 1.7 - 3.0 m³

Spreader



Keywords

#Counties, Cities & Municipalities #Contractors #Deicing #Highways & Main Roads #Innercity Roads #Parking Facilities & Underground Car Parks #Industrial & Port Areas

Technical data

	Galeox 40	Galeox 50
Hopper		
Hopper capacity	4 m ³	5 m ³
Conveyor system		
Conveyor system	belt	belt
Distribution system		
Distribution systems	Spreading disc: Premium 5-zone mixing system: Spreading disc diameter: 490 mm Spreading width: 2 - 10 m	Spreading disc: Premium 5-zone mixing system: Spreading disc diameter: 490 mm Spreading width: 2 - 10 m
Mounting/demount system		
Mounting/demount system	Hoofklift	Hoofklift
Drive system		
Type of drive	Vehicle hydraulics / Engine drive / rotopower / Wheel drive	Vehicle hydraulics / Engine drive / rotopower / Wheel drive
Control system		
Control system	EP / EC	EP / EC
Weights		
Empty weight approx.	870 kg	950 kg
	Galeox 60	Galeox 70
Hopper		
Hopper capacity	6 m ³	7 m ³
Conveyor system		
Conveyor system	belt	belt
Distribution system		
Distribution systems	Spreading disc: Premium 5-zone mixing system: Spreading disc diameter: 490 mm Spreading width: 2 - 10 m	Spreading disc: Premium 5-zone mixing system: Spreading disc diameter: 490 mm Spreading width: 2 - 10 m
Mounting/demount system		
Mounting/demount system	Hoofklift	Hoofklift
Drive system		
Type of drive	Vehicle hydraulics / Engine drive / rotopower / Wheel drive	Vehicle hydraulics / Engine drive / rotopower / Wheel drive
Control system		
Control system	EP / EC	EP / EC
Weights		
Empty weight approx.	1,000 kg	1,070 kg



www.aebi-schmidt.com
 © Aebi Schmidt Group
 Aebi Schmidt Holding AG
 CH-8050 Zurich

All rights reserved. Technical data is subject to change. Illustrations are not binding. Errors and amendments excepted.

Document created on 26 Feb 2021

